



Specification

Product: COB LENS

MODEL: AHCOB6838D24G

DATE: 2013-8-25

ASAHI OPTICS LIMITED



2/F SHALING BUILDING, SHAJING, BAO'AN SHENZHEN' CHINA
TEL: +86-755-85241681 FAX: +86-755-83877899 EMAIL: OPTICS@ASAHI-OPTICS.COM

Prepared by	Checked by	Approved by
T.C.SUN	H.J.HU	Z.Y.LIU



Index

1. Cover
2. Index
3. Product description
4. Drawing
5. Test report
6. Material certificate

Part Number	AHCOB6838D24G
Picture	
Dimension	68.0*38.50mm
LED Type	
Beam Angle	24°
Efficiency	90%
Material	PMMA

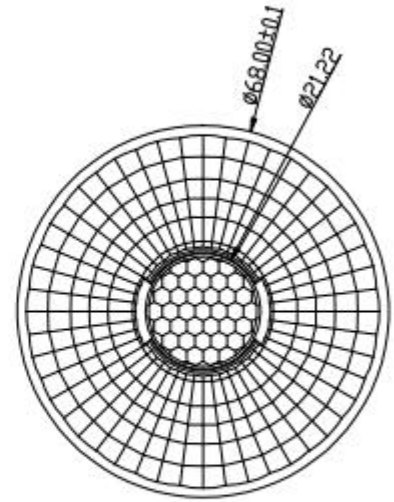
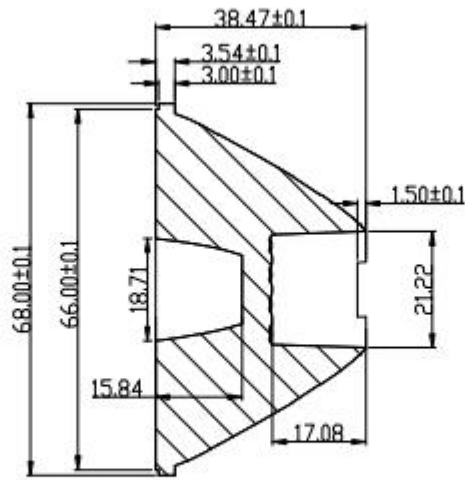
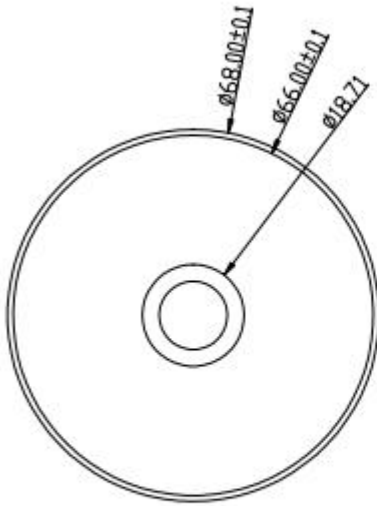



GO1900L GONIOPHOTOMETER Test Report Page 1 Of 2

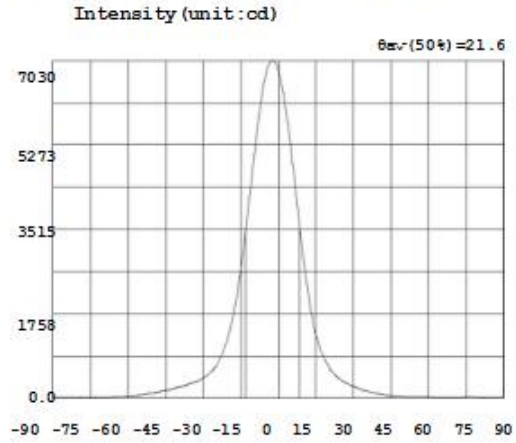
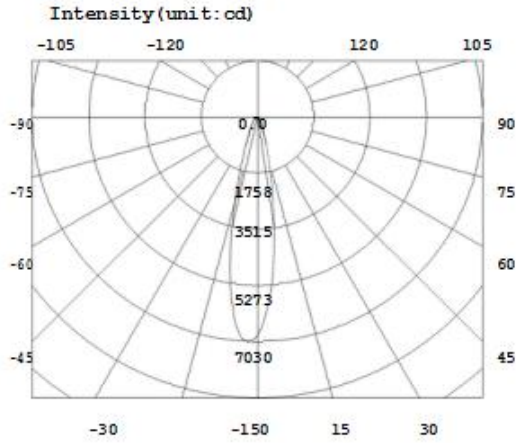

Intensity data: (deg , cd) CO-180

A	I	A	I	A	I	A	I	A	I	A	I
-90.0	10.06	-58.0	52.85	-26.0	600.1	6.0	4748	38.0	110.8	70.0	22.55
-88.0	10.14	-56.0	61.30	-24.0	753.4	8.0	3809	40.0	88.57	72.0	23.12
-86.0	11.20	-54.0	74.49	-22.0	981.5	10.0	2909	42.0	71.35	74.0	23.84
-84.0	10.58	-52.0	90.34	-20.0	1293	12.0	2154	44.0	59.62	76.0	24.69
-82.0	10.74	-50.0	107.7	-18.0	1732	14.0	1556	46.0	51.40	78.0	23.91
-80.0	11.40	-48.0	127.2	-16.0	2327	16.0	1143	48.0	42.92	80.0	15.21
-78.0	12.19	-46.0	148.8	-14.0	3082	18.0	868.7	50.0	34.94	82.0	14.92
-76.0	12.90	-44.0	171.3	-12.0	3973	20.0	676.3	52.0	30.21	84.0	23.15
-74.0	13.99	-42.0	196.2	-10.0	4887	22.0	522.7	54.0	26.81	86.0	21.50
-72.0	15.73	-40.0	222.4	-8.0	5777	24.0	421.7	56.0	25.44	88.0	17.81
-70.0	18.25	-38.0	251.8	-6.0	6497	26.0	348.3	58.0	24.69	90.0	13.85
-68.0	21.35	-36.0	288.0	-4.0	6922	28.0	292.5	60.0	24.23		
-66.0	25.15	-34.0	325.1	-2.0	7025	30.0	246.3	62.0	23.64		
-64.0	29.66	-32.0	363.5	0.0	6834	32.0	203.1	64.0	22.84		
-62.0	35.08	-30.0	421.1	2.0	6335	34.0	166.0	66.0	22.43		
-60.0	42.63	-28.0	499.3	4.0	5621	36.0	136.6	68.0	22.22		

Electricity Parameter:

Current I: 0.6800A Power: 0.0W
Voltage V: 36.00V PF: 0.000

Optical Parameter (Distance=3.000m) :

Equivalent Luminous flux: $\Phi_{eff} = 1658lm$ Efficiency: $Eff=0.00lm/W$
Diffuse angle: @ (25%): 31.1deg @ (50%): 21.6deg @ (75%): 13.9deg @ (50%): 21.6deg
Diffuse angle: @ (25%): 31.4deg @ (50%): 22.0deg @ (75%): 14.5deg @ (50%): 22.0deg
 $I_{max}=7025cd$ (C=0.0deg,G=-2.0deg) CO-180Plane $I_{max}= 7025cd(G=-2.0deg)$
CO-180Plane $I_0= 6834cd$

Lamp Type: COB LENS
Tester: ASAHI
Temperature: 25.3deg
Manufacturer: ASAHI

Luminaires Type: CREE CXA1830
Test Date: 2013-08-17
Humidity: 65%
Remarks: AHC0B6838D24G



EVERFINE 远方
www.everfine.CN

GO1900L GONIOPHOTOMETER Test Report

Page 2 Of 2

Average Illuminance Figure

Flux out:574.93 lm

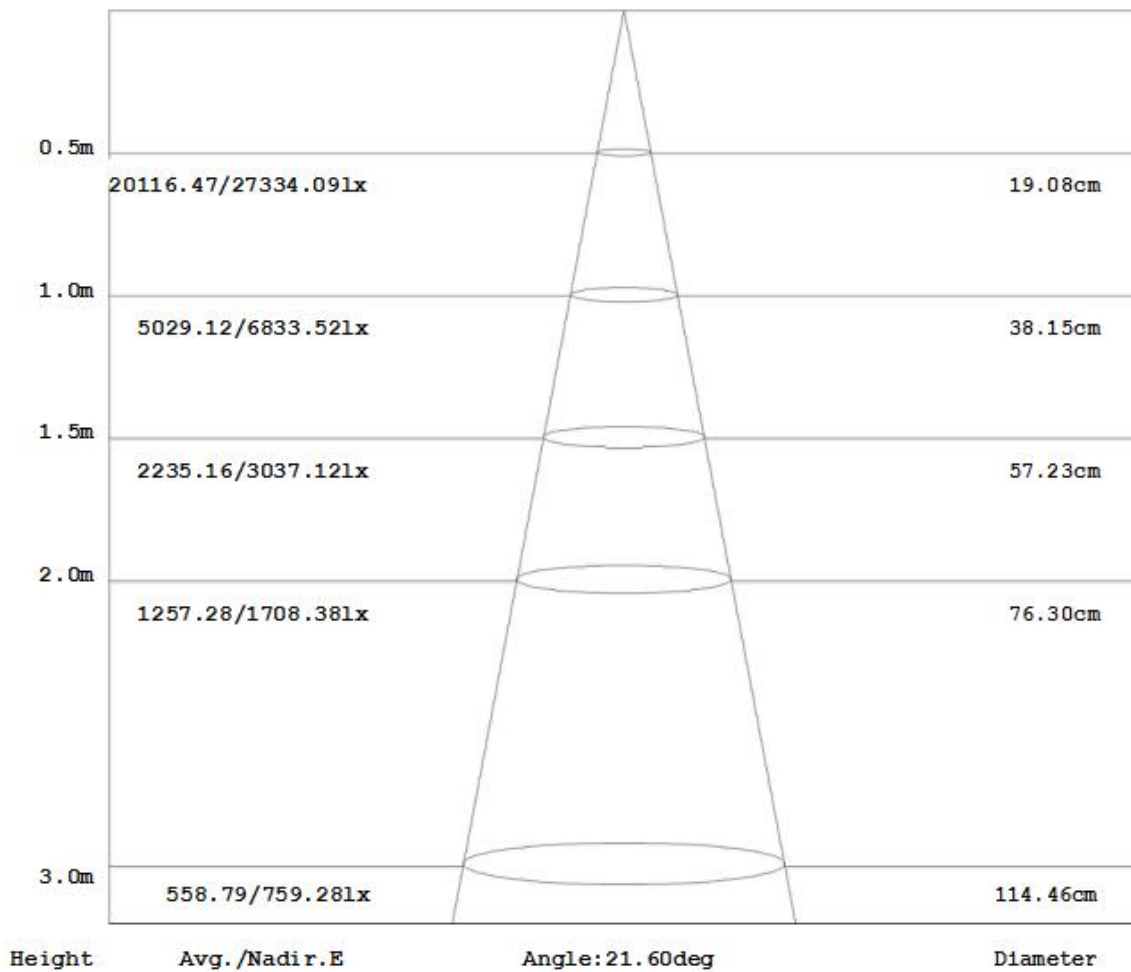

Lamp Type: COB LENS
Tester: ASAHI
Temperature: 25.3deg
Manufacturer: ASAHI

Luminaires Type: CREE CXA1830
Test Date: 2013-08-17
Humidity: 65%
Remarks: AHCOB6838D24G



15-9-30

UL Certification

iq.ul.com

Component - Plastics [guide info]

E256044

MITSUBISHI RAYON POLYMER NANTONG CO LTD

NANTONG ECONOMIC & TECH DEV AREA, 6 GUANGZHOU RD, NANTONG JIANGSU 226009 CN

VH(ww)(f1), VH(f1), VHM(f1), VHS(f1)

Polymethyl Methacrylate (PMMA), "Shinkolite-P, Acrypet", furnished as pellets

Color	Min Thk (mm)	Flame Class	HWI		RTI		RTI Str
			HWI	HAI	Elec	Imp	
ALL	1.5	HB	4	0	50	50	50
	3.0	HB	3	0	50	50	50

Comparative Tracking Index (CTI): -

Inclined Plane Tracking (IPT): -

Dielectric Strength (kV/mm): -

Volume Resistivity (10^X ohm-cm): -

High-Voltage Arc Tracking Rate (HVTR): -

High Volt, Low Current Arc Resis (D495): -

Dimensional Stability (%): -

(f1) - Suitable for outdoor use with respect to exposure to Ultraviolet Light, Water Exposure and Immersion in accordance with UL 746C.

(ww) - With or without a digit 0-3,5,7-9 incl.

ANSI/UL 94 small-scale test data does not pertain to building materials, furnishings and related contents. ANSI/UL 94 small-scale test data is intended solely for determining the flammability of plastic materials used in the components and parts of end-product devices and appliances, where the acceptability of the combination is determined by UL.

Report Date: 2013-01-02

Last Revised: 2013-01-23

© 2015 UL LLC



IEC and ISO Test Methods

Test Name	Test Method	Units	Thk (mm)	Value
Flammability	IEC 60695-11-10	Class (color)	1.5	HB75 (ALL)
			3.0	HB40 (ALL)
Glow-Wire Flammability (GWFI)	IEC 60695-2-12	C	-	-
Glow-Wire Ignition (GWIT)	IEC 60695-2-13	C	-	-
IEC Comparative Tracking Index	IEC 60112	Volts (Max)	-	-
IEC Ball Pressure	IEC 60695-10-2	C	-	-
ISO Heat Deflection (1.80 MPa)	ISO 75-2	C	-	-
ISO Tensile Strength	ISO 527-2	MPa	-	-
ISO Flexural Strength	ISO 178	MPa	-	-
ISO Tensile Impact	ISO 8256	kJ/m ²	-	-
ISO Izod Impact	ISO 180	kJ/m ²	-	-
ISO Charpy Impact	ISO 179-2	kJ/m ²	-	-