



# Specification

**Product: COB LENS**

**MODEL: AHCOB5835D15G**

**DATE: 2013-8-25**

## **ASAHI OPTICS LIMITED**



2/F SHALING BUILDING, SHAJING, BAO'AN SHENZHEN' CHINA  
TEL: +86-755-85241681 FAX: +86-755-83877899 EMAIL: [OPTICS@ASAHI-OPTICS.COM](mailto:OPTICS@ASAHI-OPTICS.COM)

| Prepared by | Checked by | Approved by |
|-------------|------------|-------------|
| T.C.SUN     | H.J.HU     | Z.Y.LIU     |



# Index

1. Cover
2. Index
3. Product description
4. Drawing
5. Test report
6. Material certificate

|                    |  |
|--------------------|--|
| <b>Part Number</b> | <b>AHCOB5835D15G</b>   |
| <b>Picture</b>     |    |
| <b>Dimension</b>   | <b>58.0*35.0mm</b>   |
| <b>LED Type</b>    |  <p> <b>CREE</b> CXA1830/2520<br/> <b>CITIZEN</b> CLL030/040<br/>         V8/V6<br/>         CHM11<br/> <b>bridgelux</b><br/> <b>LUMINUS</b> </p> |
| <b>Beam Angle</b>  | <b>15°</b>   |
| <b>Efficiency</b>  | <b>90%</b>   |
| <b>Material</b>    | <b>PMMA</b>  |

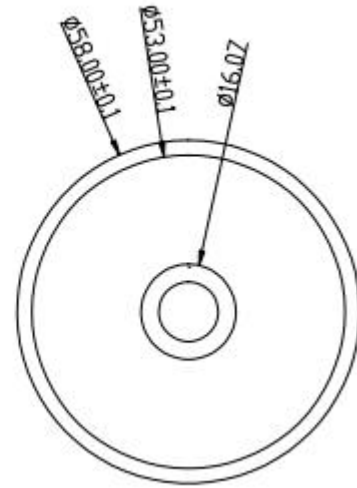
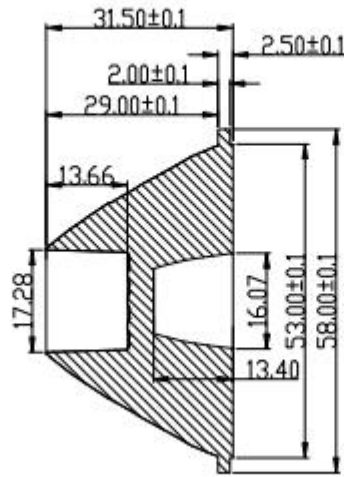
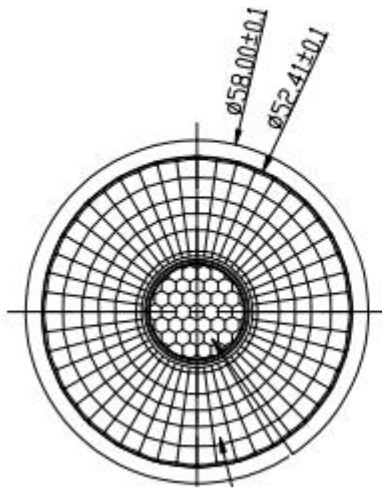



**EVERFINE** 远方  
www.everfine.CN

GO1900L GONIOPHOTOMETER Test Report Page 2 Of 2

**Average Illuminance Figure**

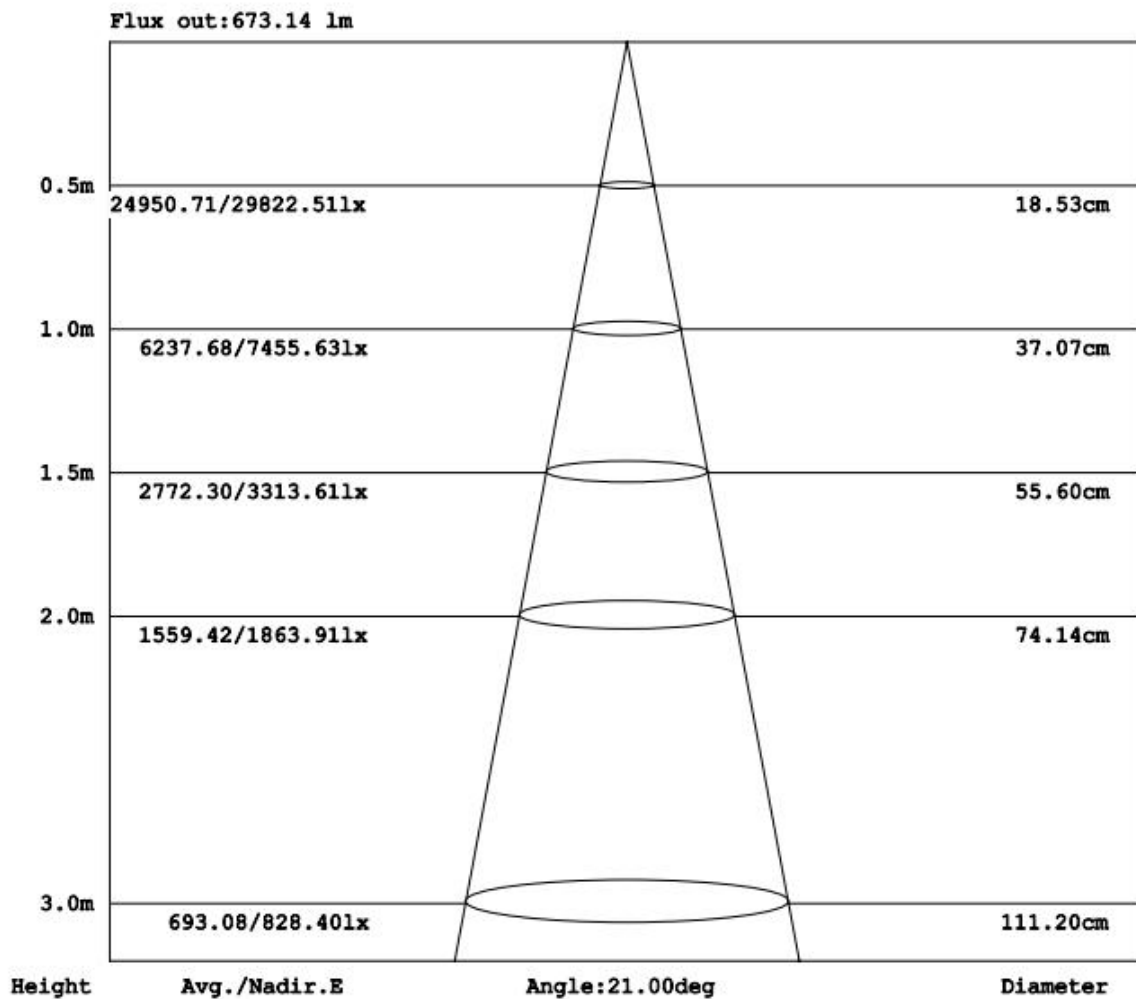

Lamp Type:COB LENS  
Tester: ASAHI  
Temperature:25.3deg  
Manufacturer: ASAHI

Luminaires Type: CREE CXA1830  
Test Date:2013-08-17  
Humidity:65%  
Remarks:



15-9-30

UL Certification

iq.ul.com

Component - Plastics [guide info]

E256044

MITSUBISHI RAYON POLYMER NANTONG CO LTD

NANTONG ECONOMIC & TECH DEV AREA, 6 GUANGZHOU RD, NANTONG JIANGSU 226009 CN

VH(ww)(f1), VH(f1), VHM(f1), VHS(f1)

Polymethyl Methacrylate (PMMA), "Shinkolite-P, Acrypet", furnished as pellets

| Color | Min Thk (mm) | Flame Class | HWI |     | RTI  |     | RTI Str |
|-------|--------------|-------------|-----|-----|------|-----|---------|
|       |              |             | HWI | HAI | Elec | Imp |         |
| ALL   | 1.5          | HB          | 4   | 0   | 50   | 50  | 50      |
|       | 3.0          | HB          | 3   | 0   | 50   | 50  | 50      |

Comparative Tracking Index (CTI): -

Inclined Plane Tracking (IPT): -

Dielectric Strength (kV/mm): -

Volume Resistivity (10<sup>X</sup> ohm-cm): -

High-Voltage Arc Tracking Rate (HVTR): -

High Volt, Low Current Arc Resis (D495): -

Dimensional Stability (%): -

(f1) - Suitable for outdoor use with respect to exposure to Ultraviolet Light, Water Exposure and Immersion in accordance with UL 746C.

(ww) - With or without a digit 0-3,5,7-9 incl.

ANSI/UL 94 small-scale test data does not pertain to building materials, furnishings and related contents. ANSI/UL 94 small-scale test data is intended solely for determining the flammability of plastic materials used in the components and parts of end-product devices and appliances, where the acceptability of the combination is determined by UL.

Report Date: 2013-01-02

Last Revised: 2013-01-23

© 2015 UL LLC



IEC and ISO Test Methods

| Test Name                      | Test Method     | Units             | Thk (mm) | Value      |
|--------------------------------|-----------------|-------------------|----------|------------|
| Flammability                   | IEC 60695-11-10 | Class (color)     | 1.5      | HB75 (ALL) |
|                                |                 |                   | 3.0      | HB40 (ALL) |
| Glow-Wire Flammability (GWFI)  | IEC 60695-2-12  | C                 | -        | -          |
| Glow-Wire Ignition (GWIT)      | IEC 60695-2-13  | C                 | -        | -          |
| IEC Comparative Tracking Index | IEC 60112       | Volts (Max)       | -        | -          |
| IEC Ball Pressure              | IEC 60695-10-2  | C                 | -        | -          |
| ISO Heat Deflection (1.80 MPa) | ISO 75-2        | C                 | -        | -          |
| ISO Tensile Strength           | ISO 527-2       | MPa               | -        | -          |
| ISO Flexural Strength          | ISO 178         | MPa               | -        | -          |
| ISO Tensile Impact             | ISO 8256        | kJ/m <sup>2</sup> | -        | -          |
| ISO Izod Impact                | ISO 180         | kJ/m <sup>2</sup> | -        | -          |
| ISO Charpy Impact              | ISO 179-2       | kJ/m <sup>2</sup> | -        | -          |