

Specification

Product: COB LENS

MODEL: AHCOB6838D60G

DATE: 2013-8-25

ASAHI OPTICS LIMITED



2/F SHALING BUILDING, SHAJING, BAO'AN SHENZHEN' CHINA
TEL: +86-755-85241681 FAX: +86-755-83877899 EMAIL: OPTICS@ASAHI-OPTICS.COM

Prepared by	Checked by	Approved by
T.C.SUN	H.J.HU	Z.Y.LIU



Index

1. Cover
2. Index
3. Product description
4. Drawing
5. Test report
6. Material certificate

Part Number	AHCOB6838D60G
Picture	
Dimension	68.0*38.50mm
LED Type	
Beam Angle	60°
Efficiency	90%
Material	PMMA

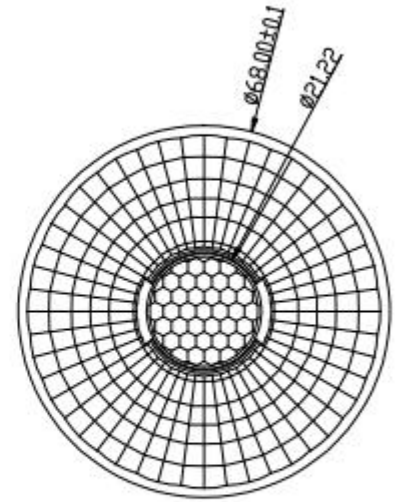
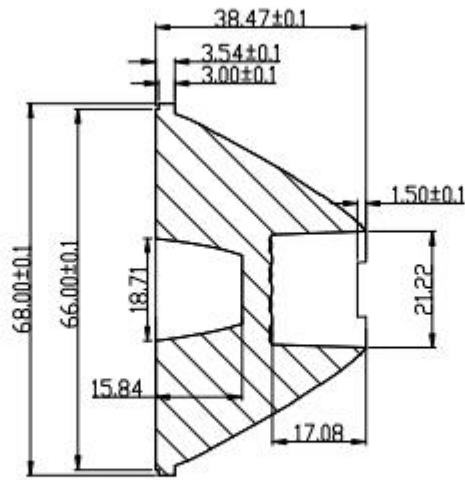
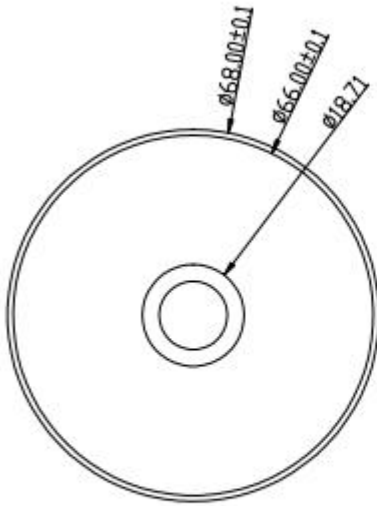

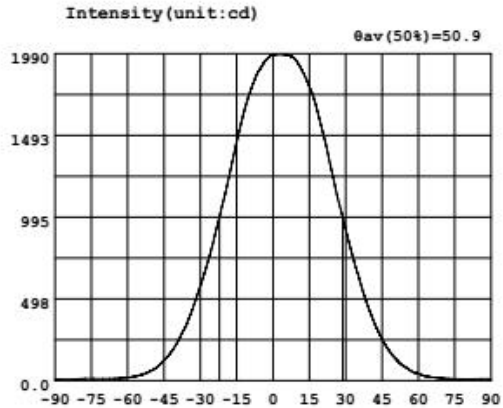
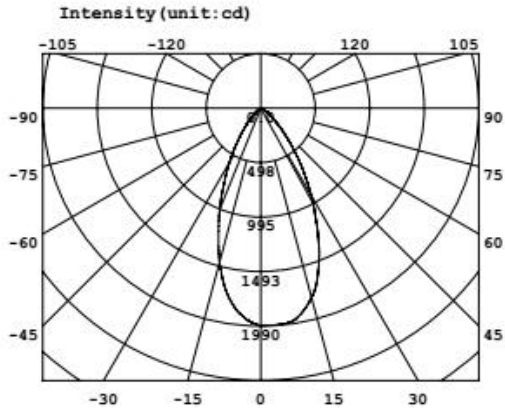

Intensity data:(deg , cd) C0-180

A	I	A	I	A	I	A	I	A	I	A	I
-90.0	10.29	-58.0	23.00	-26.0	768.8	6.0	1981	38.0	504.1	70.0	14.92
-88.0	9.527	-56.0	29.55	-24.0	885.0	8.0	1971	40.0	421.7	72.0	13.07
-86.0	8.883	-54.0	36.77	-22.0	1002	10.0	1939	42.0	345.8	74.0	11.57
-84.0	9.089	-52.0	48.84	-20.0	1123	12.0	1888	44.0	283.2	76.0	10.62
-82.0	9.419	-50.0	62.83	-18.0	1252	14.0	1826	46.0	227.5	78.0	10.00
-80.0	10.59	-48.0	80.77	-16.0	1387	16.0	1756	48.0	181.0	80.0	9.709
-78.0	12.47	-46.0	108.7	-14.0	1517	18.0	1660	50.0	142.9	82.0	10.02
-76.0	13.19	-44.0	138.5	-12.0	1634	20.0	1546	52.0	111.5	84.0	10.63
-74.0	12.70	-42.0	175.0	-10.0	1735	22.0	1427	54.0	88.42	86.0	11.03
-72.0	12.10	-40.0	220.4	-8.0	1815	24.0	1291	56.0	69.04	88.0	11.28
-70.0	12.34	-38.0	275.6	-6.0	1883	26.0	1158	58.0	51.40	90.0	10.57
-68.0	12.49	-36.0	331.1	-4.0	1929	28.0	1041	60.0	43.27		
-66.0	13.26	-34.0	405.3	-2.0	1965	30.0	921.6	62.0	31.26		
-64.0	14.52	-32.0	488.4	0.0	1983	32.0	806.3	64.0	24.66		
-62.0	16.30	-30.0	576.5	2.0	1984	34.0	699.2	66.0	21.03		
-60.0	19.05	-28.0	667.9	4.0	1985	36.0	600.4	68.0	17.59		

Electricity Parameter:

Current I: 0.6800A Power: 0.0W
Voltage V: 36.00V PF: 0.000

Optical Parameter (Distance=3.000m) :

Equivalent Luminous flux: $\Phi_{eff} = 1664lm$ Efficiency: $Eff=0.00lm/W$
Diffuse angle: @ (25%): 69.9deg @ (50%): 50.9deg @ (75%): 35.3deg @ (50%): 50.9deg
Diffuse angle: @ (25%): 69.9deg @ (50%): 50.9deg @ (75%): 35.3deg @ (50%): 50.9deg
Imax=1986cd (C=0.0deg,G=1.0deg) C0-180Plane Imax= 1986cd(G=1.0deg)
C0-180Plane IO= 1983cd

Lamp Type:COB LENS
Tester: ASAHI
Temperature:25.3deg
Manufacturer: ASAHI

Luminaires Type: CREE CXA2530
Test Date:2013-08-17
Humidity:65%
Remarks:AHCOB6838D60G

Average Illuminance Figure

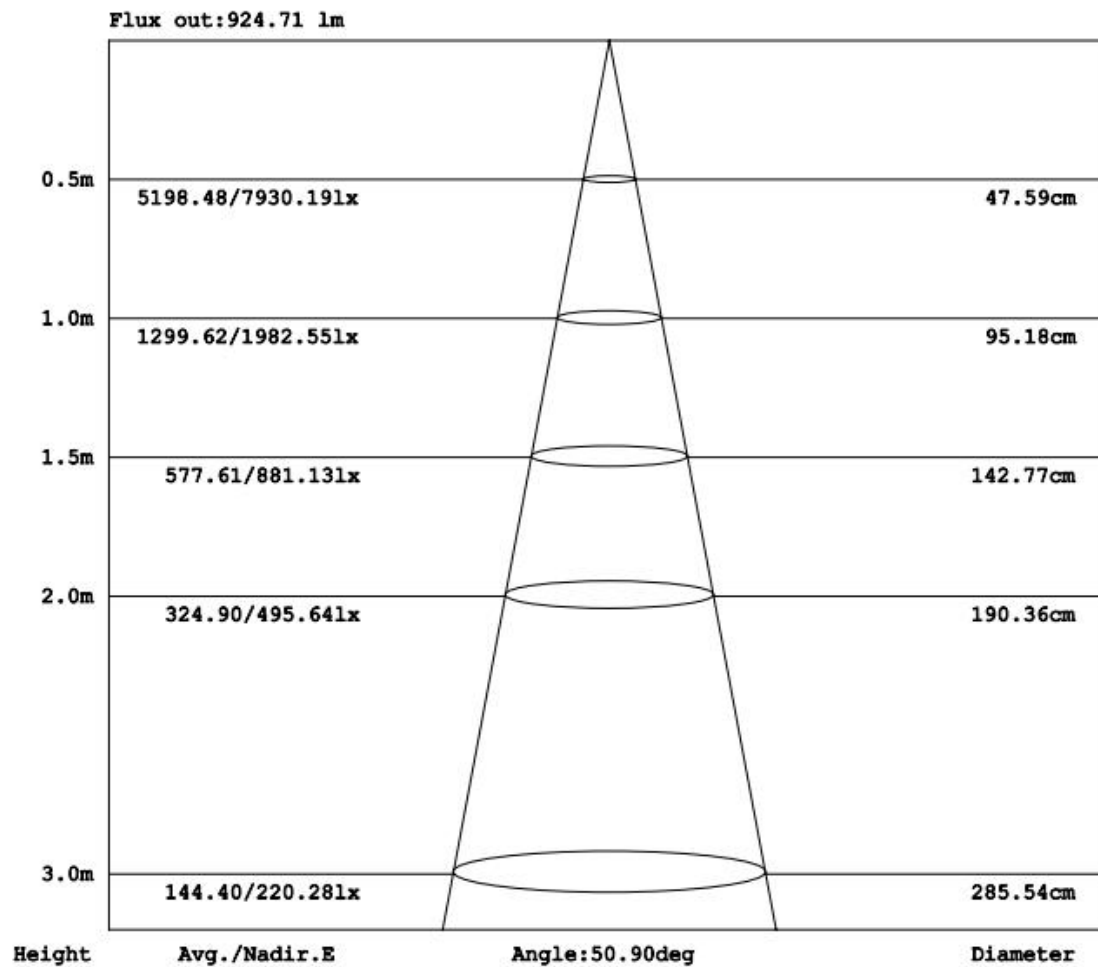

Lamp Type:COB LENS
 Tester: ASAHI
 Temperature:25.3deg
 Manufacturer: ASAHI

Luminaires Type: CREE CXA2530
 Test Date:2013-08-17
 Humidity:65%
 Remarks:AHCOB6838D60G



15-9-30

UL Certification

iq.ul.com

Component - Plastics [guide info]

E256044

MITSUBISHI RAYON POLYMER NANTONG CO LTD

NANTONG ECONOMIC & TECH DEV AREA, 6 GUANGZHOU RD, NANTONG JIANGSU 226009 CN

VH(ww)(f1), VH(f1), VHM(f1), VHS(f1)

Polymethyl Methacrylate (PMMA), "Shinkolite-P, Acrypet", furnished as pellets

Color	Min Thk (mm)	Flame Class	RTI		RTI		RTI Str
			HWI	HAI	Elec	Imp	
ALL	1.5	HB	4	0	50	50	50
	3.0	HB	3	0	50	50	50

Comparative Tracking Index (CTI): -

Inclined Plane Tracking (IPT): -

Dielectric Strength (kV/mm): -

Volume Resistivity (10^X ohm-cm): -

High-Voltage Arc Tracking Rate (HVTR): -

High Volt, Low Current Arc Resis (D495): -

Dimensional Stability (%): -

(f1) - Suitable for outdoor use with respect to exposure to Ultraviolet Light, Water Exposure and Immersion in accordance with UL 746C.

(ww) - With or without a digit 0-3,5,7-9 incl.

ANSI/UL 94 small-scale test data does not pertain to building materials, furnishings and related contents. ANSI/UL 94 small-scale test data is intended solely for determining the flammability of plastic materials used in the components and parts of end-product devices and appliances, where the acceptability of the combination is determined by UL.

Report Date: 2013-01-02

Last Revised: 2013-01-23

© 2015 UL LLC



IEC and ISO Test Methods

Test Name	Test Method	Units	Thk (mm)	Value
Flammability	IEC 60695-11-10	Class (color)	1.5	HB75 (ALL)
			3.0	HB40 (ALL)
Glow-Wire Flammability (GWFI)	IEC 60695-2-12	C	-	-
Glow-Wire Ignition (GWIT)	IEC 60695-2-13	C	-	-
IEC Comparative Tracking Index	IEC 60112	Volts (Max)	-	-
IEC Ball Pressure	IEC 60695-10-2	C	-	-
ISO Heat Deflection (1.80 MPa)	ISO 75-2	C	-	-
ISO Tensile Strength	ISO 527-2	MPa	-	-
ISO Flexural Strength	ISO 178	MPa	-	-
ISO Tensile Impact	ISO 8256	kJ/m ²	-	-
ISO Izod Impact	ISO 180	kJ/m ²	-	-
ISO Charpy Impact	ISO 179-2	kJ/m ²	-	-